

alferpro®

SEALING –
ISOLATING – DRAINING

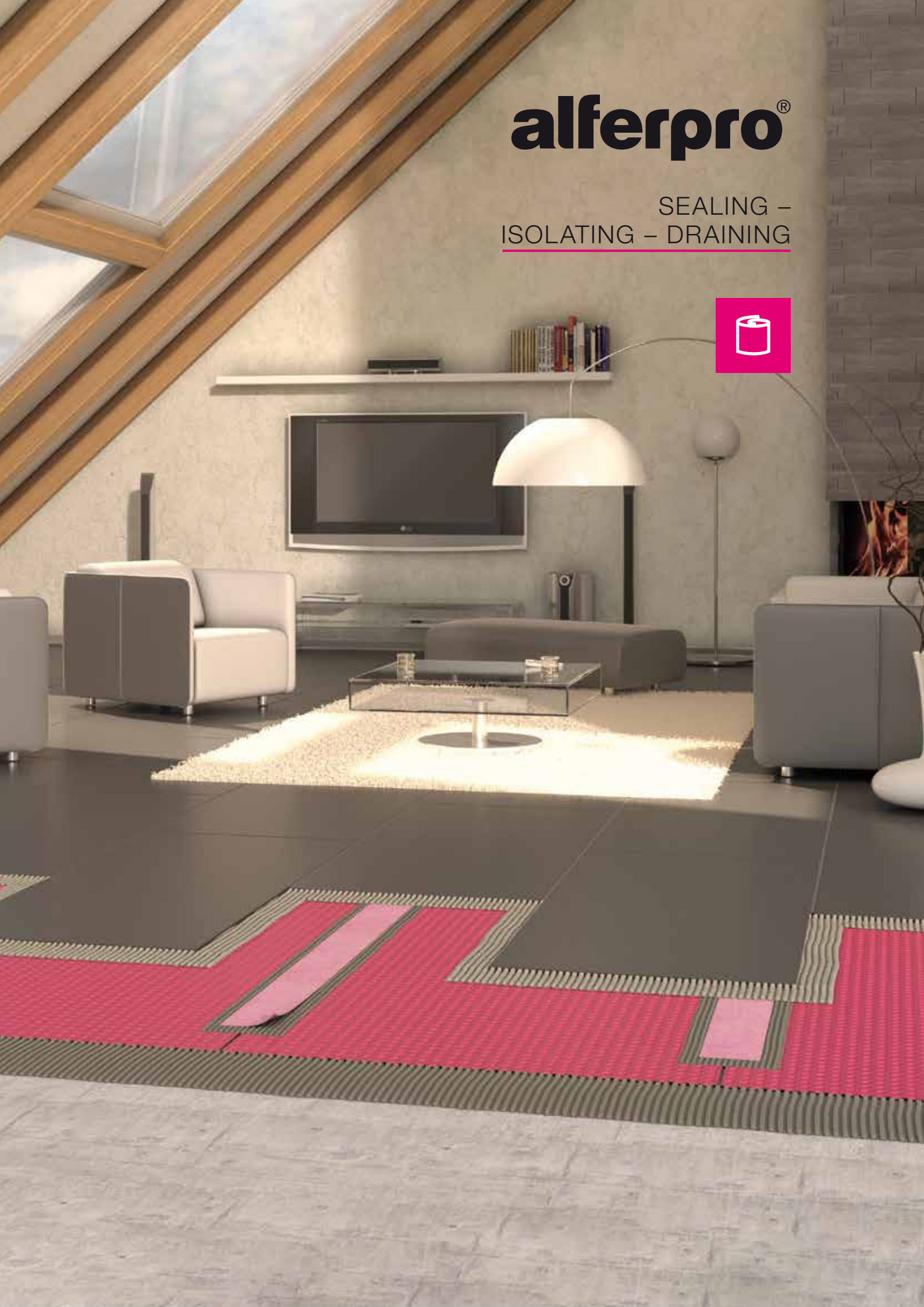



alferground

SEALING – ISOLATING – DRAINING

This plan is waterproof! With the alferground range we offer a highly reliable solution for the building expansion and renovation of indoor and outdoor wet and damp areas.

Isolate the substrate from the covering. Our mats, bands and sheets are an effective protection against cracking. Prolong the durability of coverings in damp and wet areas. Our alferground range products for indoor and outdoor use are 100% water impermeable and protect moisture sensitive substrates. You can ensure perfect dewatering of loosely laid coverings, such as gravel or grit, with our drainage mat.

Overview	04 - 05
Sealing sheet AG DB 30	06 - 07
Sealing and isolating sheet AG DB EK 15	08 - 09
Isolation mat AG EK 30	10 - 11
Drainage mat AG DM 15	12 - 13





alferground

SEALING – ISOLATING

TESTED WITH AbP



Sealing sheets, isolation mats and accessories of the alferground range are ideally designed for the reliable sealing of damp and wet indoor & outdoor spaces and on underfloor heatings.

COMPLIANT WITH
DIN 18534



1. SEALING SHEET 30 m²



- For sealing of damp and wet spaces in indoor and outdoor areas
- Suitable for underfloor heatings
- Material: PP/PE, fleeced
- Polypropylene fleece, top and bottom sides
- Modified low-density polyethylene sealing layer
- Colour: magenta
- 1 m wide

2. SEALING AND ISOLATING SHEET 15 m²



- Sealing and isolating sheet for damp and wet areas – for indoor and outdoor use
- Material: PP/PE fleeced
- Sealing sheet with isolating effect
- High adhesive tensile strength and crack-bridging
- High water vapour diffusion resistance
- Colour: magenta

3. SEALING STRIP



- Seals the joints of two sealing sheets.
- Seals reliably in damp and wet areas – for indoor and outdoor use
- Suitable for underfloor heatings
- Material: PP/PE-fleece, top and bottom sides with thermoplastic elastomer
- Colour: magenta
- 12 cm wide
- 25 running metre

4. INTERNAL CORNER



- Ready to use welded molded component for the isolation of internal corners
- Material: PP/PE-fleece, top and bottom sides with thermoplastic elastomer
- Colour: magenta

5. EXTERNAL CORNER



- Ready to use welded molded component for the isolation of external corners
- Material: PP/PE-fleece, top and bottom sides with thermoplastic elastomer
- Colour: magenta

6. WALL SLEEVE



- Prefabricated moulded component designed to seal wall pipe protrusions
- Material: PP/PE-fleece, top and bottom sides with thermoplastic elastomer
- Colour: magenta

7. FLOOR COLLAR



- Prefabricated moulded component designed to seal shower floor pipe protrusions
- Material: PP/PE-fleece, top and bottom sides with thermoplastic elastomer
- Colour: magenta

alferground

SEALING – ISOLATING



SEALING SHEET 30 m²

The alferground sealing sheet AG DB 30 is ideal for reliable surface sealing in combination with tiles and panels indoors and outdoors. Use in damp and wet rooms, as well as balconies and terraces. The sealing sheet fulfills the requirements of DIN 18534 waterproofing of interior spaces and level-access showers.

Mat thickness: approx. 0.5 mm
Material: PP/PE, fleeced
Carrier: Polypropylene fleece, top and bottom sides
Membrane: Polyethylene film
Weight: approx. 307 g/m²
Roll width: 1 m
Roll length: 30 m



LAYER STRUCTURE

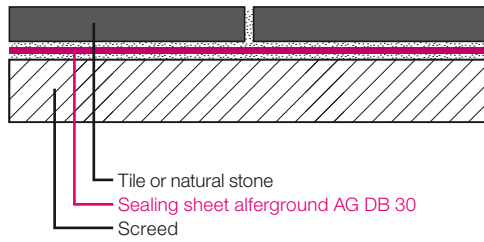

LAYING

The surfaces on which the sealing sheet is to be applied must be dry or damp, solid, stable and torsion-free. Also free of dust, impurities or other contaminant agents.

The sealing sheet and strips, as well as the accessories, must be cut and adjusted to the appropriate size before starting laying.

On the prepared underlying surface, the internal and external corners and then the sealing strips are glued uniformly on the floor/wall transitions and in the area of the wall corners. The overlap is at least 5 cm.

For implementing the surface sealing of the walls and floor areas, it is necessary to apply a C2 tile adhesive evenly according to the manufacturer's instructions, using a 4 x 4 mm notched trowel up to the fleece edges of the surface of the sealing strip. The sheets are then fully bonded. The sheets are laid in the transitions and corners up to the edge, so that the sheets are positioned on the surface one after the other with an overlay of at least 5 cm. Through a strong pressing of the sealing strip a uniform bonding is obtained. In order to prevent air bubbles entrapment, press and laterally spread with a smoothing trowel. When using normal tiles, no drying time is required.

Intersections and assembly components must be sealed with the corresponding wall and floor sleeves.

ACCESSORIES

Sealing strip, internal and external corners, wall sleeve and floor collar



alferground

SEALING – ISOLATING



SEALING AND ISOLATING SHEET 15 m²

The alferground sealing and isolating sheet AG DB EK 15 is used for safe decoupling and optimal waterproofing in combination with tiles and slabs both indoors and outdoors. Ideal for a reduced installation height.

The product is suitable as a sealing material for the moisture exposure classes A and B0, but only for the floor (for example, domestic bathrooms, sales areas with large-format tiles, balconies and terraces - not above living quarters).

Mat thickness: approx. 0,9mm
Material: PP/PE fleeced
Weight: approx. 375g/m²
Roll width: 1 m
Roll length: 15m



LAYER STRUCTURE

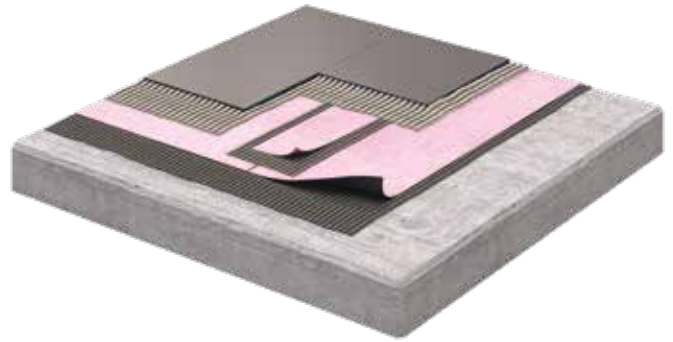
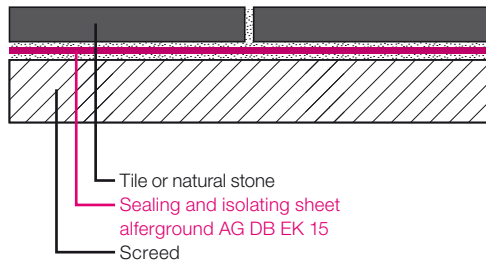

LAYING

The surfaces on which the sealing and isolating sheet is to be applied must be dry or damp, solid, stable and torsion-free. Also free of dust, impurities or other contaminant agents.

The sealing sheet and strips, as well as the accessories, must be cut and adjusted to the appropriate size before starting laying tiles.

As a first step, on the prepared underlying surface, the internal and external corners and then the sealing strips are glued in full contact with the joints in the floor/wall transition as well as in the area of the wall corners. The overlap is at least 5 cm.

For implementing the surface sealing of the walls and floor areas, it is necessary to apply evenly a C2 tile adhesive according to the manufacturer's instructions, using a 4 x 4 mm notched trowel up to the fleece edges of the surface of the sealing strip. The sheets are then fully bonded. The sheets are laid in the transitions and corners up to the edge, so that the sheets are positioned on the surface one after the other with an overlay of at least 5 cm. Through a strong pressing of the sealing strip a uniform bonding is obtained. In order to prevent air bubbles entrapment, press and lateraly spread with a smoothing trowel. When using normal tiles, no drying time is required.

ACCESSORIES

Sealing strip, internal and external corners



alferground

SEALING – ISOLATING



ISOLATION MAT 30 m²

With alferground you can isolate coverings from the substrate and seal them against moisture. Tensions are bypassed, thus avoiding the formation of cracks. The 3-dimensional HDPE plastic mats with under-side fleece find application in indoor and outdoors areas. The mats are perfect for laying directly on the screed, even when the concrete isn't fully hardened. Ideal for wooden or mixed substrates. Also suitable for underfloor heatings.

Mat thickness: approx. 3 mm
Material: Plastic HDPE
Weight: approx. 570 g/m²
Roll width: 1 m
Roll length: 30 m



LAYER STRUCTURE

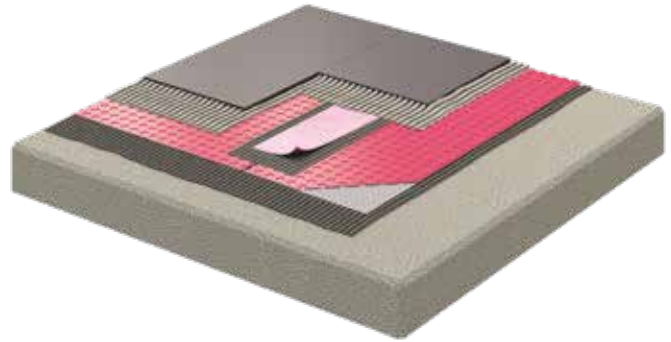
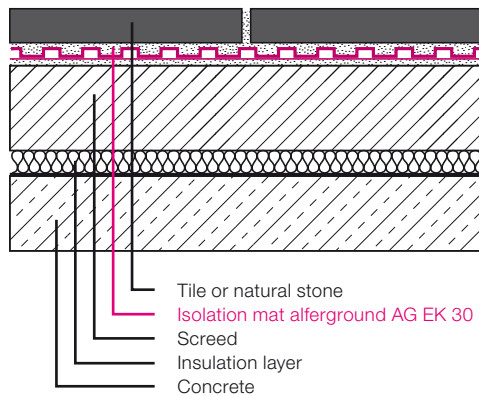

LAYING

The surfaces on which the sealing and isolating sheet is to be applied must be dry or damp, solid, stable and torsion-free. Also free of dust, impurities or other contaminant agents. Underlying surfaces must be pre-treated if necessary beforehand according to their type.

The isolating mat and accessories must be cut and adjusted to the appropriate size before starting laying tiles.

Avoid rigidly fitting the ceramic layer and the isolation mat; minimum width of junction 5 – 10 mm.

The thin-layer mortar must be applied with a suitable spatula (a 4 x 4 mm notched trowel is recommended). The choice of adhesive depends on the respective underlying: you can choose between a flexible hydraulic mortar or a quick setting mortar (DIN EN 12004/C2). The technical data sheets of the adhesive manufacturer must be observed. The isolation mats are pressed evenly using a suitable tool, the fleeced surface facing the adhesive layer. The joining points of the mats are covered with the sealing strip. The tile laying (thin layer mortar method) can be started immediately after laying the sealing mat. If it is necessary to start immediately with the laying of the tiles, it is advisable to spread the adhesive in the cavities of the mat and comb the mortar thinly in a single step. A full bonding of the tiles must be ensured. Minimum tile size: 50 x 50 mm. Lower thickness tiles don't provide adequate durability in these settings because there is a high risk of breakage.

ACCESSORIES

Sealing strip



alferground

DRAINING



DRAINAGE MAT 15 m²

The drainage mat ensures reliable drainage in outdoor areas. The mat is laid under the drainage screed or loosely on the gravel/crushed stone bed. The dimensionally stable dimpled structure ensures that the drainage space is permanent.

Mat thickness:	approx. 8 mm
Material:	Plastic HDPE
Weight:	approx. 600 g/m ²
Roll width:	1 m
Roll length:	15 m
Pressure resistance:	max. 240 kN/m ² (24 t/m ²)
Drainage performance in accordance with EN ISO 12958	



LAYER STRUCTURE

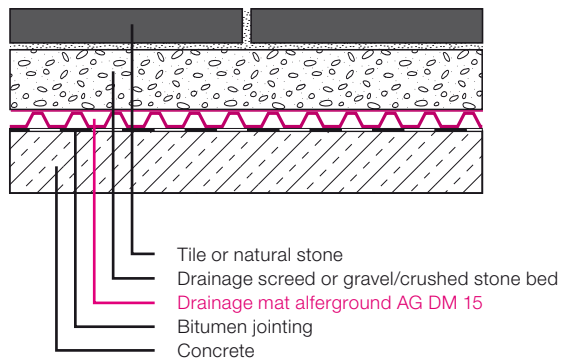

LAYING

The underlying surface must have a slope of approx. 2%. If compensation measures are required for the underlying surface, these shall be completed before laying.

The drainage mat with the reticulated fabric facing upwards is unrolled onto the structural sealing. In case of transversal laying, the reticulated fabric is folded for at least three rows of knobs and overlapped on the nodes. In case of longitudinal laying it is possible to use the stackable edge (7 cm). If the overlapping is done correctly, no water can get under the drainage mat. Subsequently, the gravel/grit bed or the draining substrate is applied in layers of corresponding thickness. Finally, depending on the surface covering, the sheets are then applied or glued either loosely or with an appropriate method.

Our drainage mats are closed polyethylene sheets, coupled with welded reticulated fabric and knots made on one side. They are drainage and foundation protective films DIN EN ISO 13252 CE certified and meet the DIN 4095 and DIN 18195 standards (waterproofing of buildings). The welded reticulated fabric coupled with knots allows the formation of an air layer, which ensures a safe drainage of condensation water.

CUSTOMER SERVICE

Together for success.

We see ourselves as a partner for your building projects. Therefore, the alferpro sales team is at your service anytime with useful advice. Your requests and orders will be attended to by our sales service. You will be also technically well supported by our sales team. Feel free to contact us with any questions.

We'd be happy to help:

Telephone **+49 7746 / 9201 500**
Fax **+49 7746 / 9201 8500**
E-Mail **info.eng@alferpro.com**



alferpro[®]

Industriestrasse 7 · 79793 Wutoeschingen · Germany
Tel +49 7746 92 01 500 · Fax +49 7746 92 01 85 00

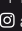
  alferpro · info.eng@alferpro.com · www.alferpro.com

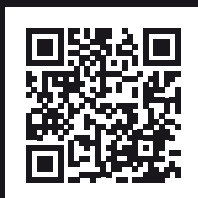

EAN 4 058012 971623

