

# alferpro<sup>®</sup>

BALCONIES AND TERRACES





# alferbal

## THE PERFECT SOLUTION FOR YOUR BALCONY

**Designed to meet the special requirements on terraces and balconies.**

Characterized by a high robustness, alferbal range defies any weather. Whether they are installed in new buildings or later in restored ones, the profiles protect efficiently the sensitive perimeter areas, against rain and adverse weather conditions. The drainage profiles can drain the water and moisture quickly. In combination with the alferground range an effective drainage is achieved.





# alferbal

## THE PERFECT SOLUTION FOR YOUR BALCONY

alferbal – Balcony angle profile for perimeter areas of balconies and terraces.  
Protection of the screed edge against weathering.  
The profile provides a clean and neat edge appearance.

Heights: 40 mm, 55 mm, 75 mm, 95 mm  
Length: 300 cm  
Material: Stainless steel V2A, aluminium powder coated  
Colours: Glossy, white, manhattan, mud brown, grey brown, beige, silver metallic, graphite metallic

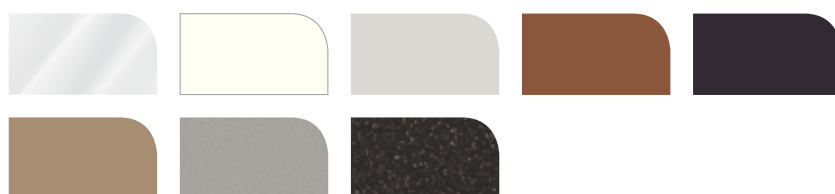
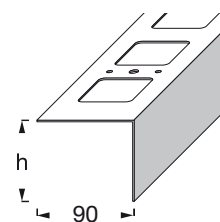

### LAYER STRUCTURE

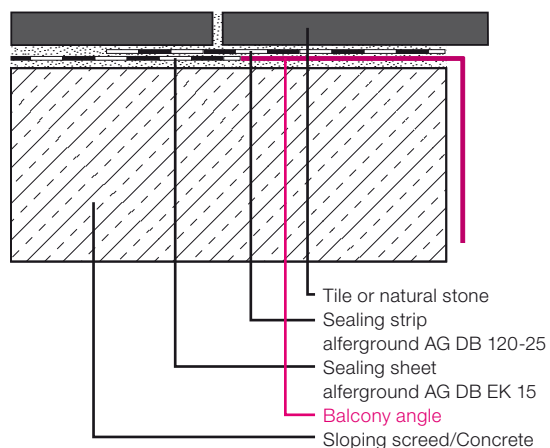

### ACCESSORIES

Matching connectors and corners

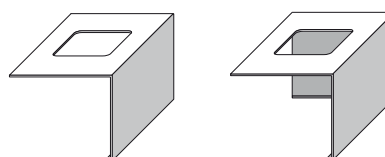

[www.alferpro.com/alferbal](http://www.alferpro.com/alferbal)



# alferbal

## DRAINAGE PROFILE

alferbal - The drainage profile with drip edge is suitable for laying on balconies, terraces and outdoor areas. The special drip edge allows an optimal drainage of water stagnations.

- Heights: 70 mm, 90 mm
- Length: 300 cm
- Material: aluminium powder coated
- Colours: manhattan, mud brown, grey brown, beige, silver metallic, graphite metallic

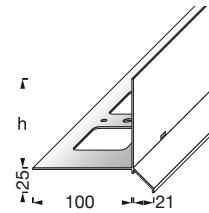

### LAYER STRUCTURE

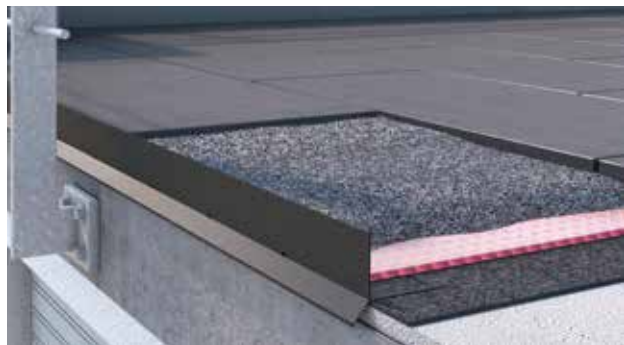
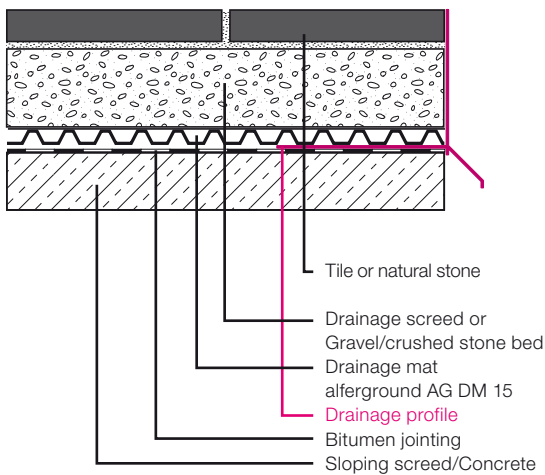

### ACCESSORIES

Matching connectors and corners

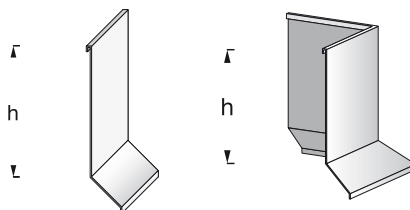



# alferbal

## DRIP EDGE PROFILE

alferbal – The drip edge profile allows the drainage of water stagnations of tiled surfaces or other cladding floor elements in outdoors areas.

- Heights: 11 mm, 13 mm, 15 mm, 23 mm
- Length: 300 cm
- Material: Aluminium natural (connector), Aluminium anodised
- Colours: Natural (connector), silver anodised

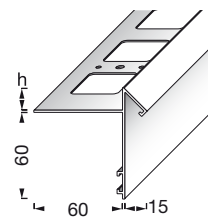

### LAYER STRUCTURE

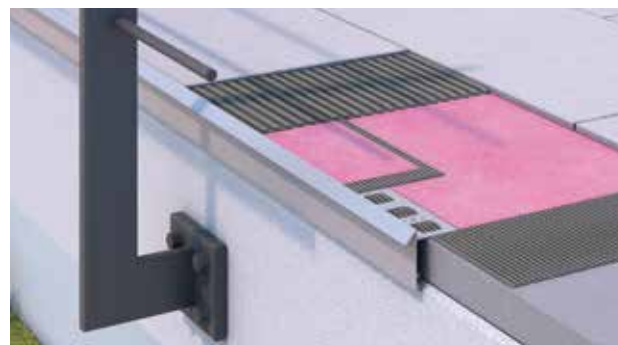
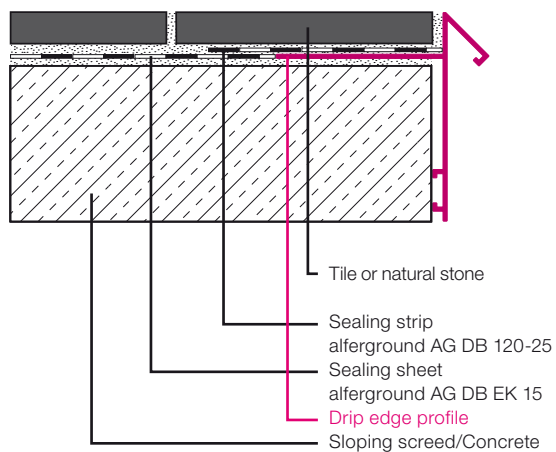

### ACCESSORIES

Matching connectors and corners

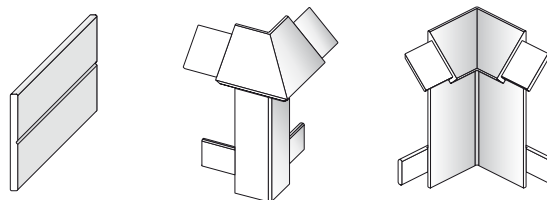



# alferground

SEALING – ISOLATING – DRAINING

**This project is waterproof! With the alferground range we offer you a highly reliable solution.**

Isolate the substrate from the covering. Our mats, bands and sheets are an effective protection against the formation of cracks. Prolong the durability of floor coverings in damp and wet areas. Our outdoors products are 100% waterproof and prevent moisture damage. In case of spaced cladding floors our drainage mats allow you to achieve an effective drainage.



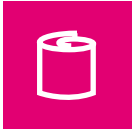

# alferground

## DRAINAGE MAT 15 m<sup>2</sup>

The drainage mat guarantees long-term, reliable drainage for your outdoors projects. The mat is laid under the drainage screed or loosely on the gravel/crushed stone bed. The stable dimpled structure ensures the long duration of the drainage space.



Mat thickness: approx. 8 mm  
Roller width: 1 m  
Roller length: 15 m  
Material: Plastic HDPE  
Weight: approx. 600 g/m<sup>2</sup>  
Pressure resistance: max. 240 kN/m<sup>2</sup> (24 t/m<sup>2</sup>)  
Drainage performance in accordance with EN ISO 12958

### LAYER STRUCTURE

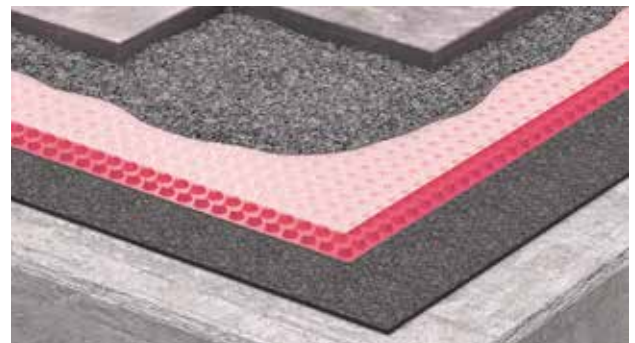
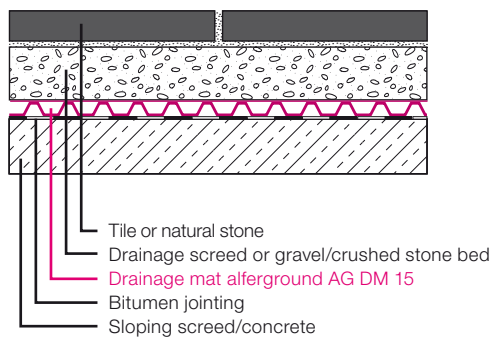



# alferground

## SEALING AND ISOLATING SHEET 15 m<sup>2</sup>

The alferground sealing and isolating sheet AG DB EK 15 is ideal for low installation heights and is suitable for walls and floors in outdoors areas. Perfect results can also be achieved with big stoneware tiles up to 1m<sup>2</sup>/plate. The 10cm scaling on the back side facilitates the cutting of the material. The special fleece on both sides constitutes an optimum bonding base between the sealing and isolating sheets and the tile glue. Suitable for use in wet duty areas classified as B0, on balconies and terraces above unused rooms/spaces.



Mat thickness: approx. 0,9mm  
Roller width: 1 m  
Roller length: 15 m  
Material: PP/PE, fleece-laminated  
Weight: approx. 375 g/m<sup>2</sup>  
Processing temperature: -5°C - +30°C

Resistant to:

- Weather effects
- Micro-organisms
- Alkaline reacting substances

### LAYER STRUCTURE

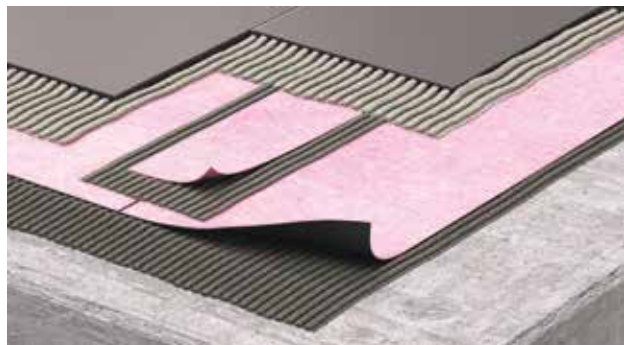
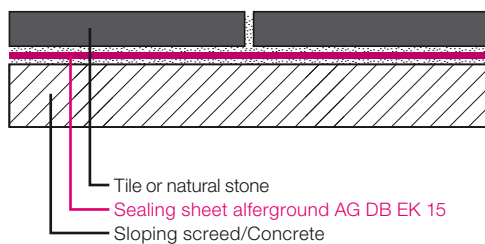

### ACCESSORIES

Sealing strip, inner and outer corner





# alferground

## SEALING – ISOLATING – DRAINING

Sealing sheets, isolation mats and system parts of alferground are ideally matched for the reliable sealing of damp and wet spaces – indoors, outdoors and in underfloor heating.

### SEALING SHEET 30 m<sup>2</sup>

Width: 100cm  
Length: 30m



### SEALING AND ISOLATING SHEET 15 m<sup>2</sup>

Width: 100cm  
Length: 15m



### SEALING STRIP

Width: 12cm  
Length: 25m



### INNER AND OUTER CORNER

Width: 14cm



### WALL SLEEVE

Width: 12cm



### FLOOR COLLAR

Width: 42,5cm



### ISOLATION MAT 30 m<sup>2</sup>

Width: 100cm  
Length: 30m



### DRAINAGE MAT 15 m<sup>2</sup>

Width: 100cm  
Length: 15m



# CUSTOMER SERVICE

---

## **Together for success.**

We see ourselves as a partner for your building projects. Therefore, the alferpro sales team is at your service anytime with useful advice. Your requests and orders will be attended to by our very comprehensive sales team. You will be well supported by the sales office team, who will give you technically sound advice with their wealth of experience. Feel free to contact us with any questions.

## **We'd be happy to help:**

**Telephone**    **+49 7746 / 9201 500**  
**Fax**            **+49 7746 / 9201 8500**  
**E-Mail**        **[info.eng@alferpro.com](mailto:info.eng@alferpro.com)**





**alferpro**<sup>®</sup>

Industriestrasse 7 · 79793 Wutoeschingen · Germany  
Tel +49 7746 92 01 50 0 · Fax +49 7746 92 01 85 00  
f alferpro · info.eng@alferpro.com · [www.alferpro.com](http://www.alferpro.com)

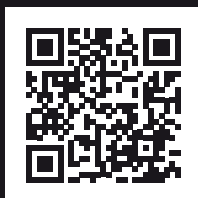

EAN 4 05801 2971326

